

Introducing the thinnest cased electrodes, ever.



infinite
biomedical technologies

ELEMENT AND IBT ELECTRODES

With a height of 6.7 mm, the IBT electrodes are the thinnest cased electrodes on the market. Combined with software-based gain adjustment, advanced signal processing, and ease of fabrication, Element is the future electrode system for the modern prosthesis.

A LOW-PROFILE SUCTION SEAL

The low-profile shape allows prosthetists to build form-fitting frames. An innovative snap-in design allows for the IBT electrodes to be pushed into the socket and still form a suction seal to secure the socket tightly onto the limb.



ADVANCED SIGNAL PROCESSING

Using digital signal processing, Element also employs industry-leading interference noise rejection to give users confidence in using their myoelectric prosthesis anywhere. The companion software enables users to fine-tune the electrode signal to their maximum potential, which includes not only gain, but smoothness and sensitivity.

WIRELESS GAIN ADJUSTMENT

The Element system has built-in Bluetooth® for wireless gain adjustment through the Element software. No more unsightly holes for manual gain adjustment – with Element, you can create a truly sealed socket.



TECHNICAL SPECS

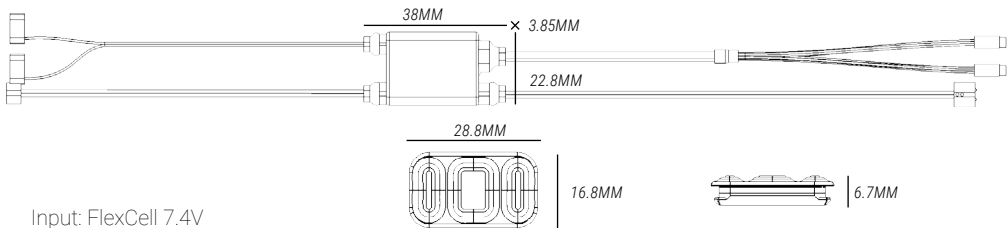

Compatibility: Element is compatible with most hands, wrists, and elbows that accept standard 3-Pin analog EMG electrode inputs. Alternative connectors may be available upon request.

Z0000082rev0 Aug 2017

CONTACT US AT

sales@i-biomed.com
(443) 451-7175